



## MR 0

### Cast resin straight-through joint

particularly for small cross sections, for polymeric cables and conductors, control cables and signal cables

Universally suitable for connecting polymeric cables or conductors insulated with PVC, PE, XLPE and EPR (e.g. N(A)YY, NYM, TT). Suitable for compression connectors on copper and aluminium conductors.

#### Characteristics

- Compact dimensions
- Splice area visible before casting
- High-quality transparent shockproof plastic shell
- Funnel clips for easy casting
- Suitable for vertical casting
- Resistant to chemical agents
- Resistant to alkaline earth elements
- Stabilized against UV rays
- Longitudinally and transversely water-tight
- High electrical insulating values
- High mechanical strength
- Ready for immediate operation
- Quick and easy assembly saves time and reduces costs

#### Application/Suitability

- Indoor
- Outdoor
- Underground
- Water
- Submersible pumps
- Installation ducts

#### Voltage level

- $U_0/U_m$  0.6/1 (1.2) kV

#### Test standards

- DIN EN 50393 (corresponds to VDE 0278)

#### Storage conditions/Shelf life

- Cast resin up to 40 months

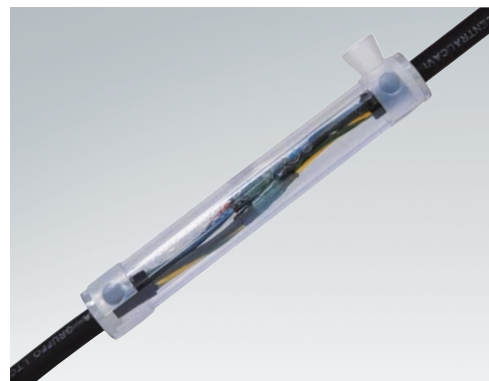



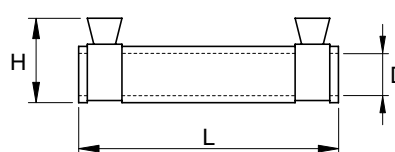

#### Dimensions



#### Scope of delivery

Cover, hydrolysis resistance PUR type EG cast resin (containing the correct volume ready for mixing), packed in practical and easy-to-use two-chamber bags, transparent plastic shell, spacers, PVC insulation tape, protective gloves, funnel clips, assembly instructions

Optional accessory: Funnel set/Filling in funnel (on request)  
 Compression connectors (see Connecting technology)  
 Cleaner UNIVERSAL CLEANER 121 (see Accessories)

|      |      |      |      |                 |   | Polymeric cable   |   |   |   |   |        |
|------|------|------|------|-----------------|---|---|---|---|---|---|--------|
|      |      |      |      |                 |   | unarmoured  |   |   |   |   |        |
|      |      |      |      |                 |   |  |  |  |  |  |        |
| Type | L mm | D mm | H mm | max. Cable-Ø mm | Nominal cross section per conductor mm <sup>2</sup> |   |   |   |   | Art.-No.  |        |
| MR   | 02   | 120  | 26   | 40              | 16  | 25  | 6   | 4   | 2.5   | 1.5   | 124507 |
|      | 05   | 180  | 26   | 40              | 16  | 25  | 6   | 4   | 4   | 2.5   | 124508 |

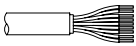
|      |      |      |      |                 |                      | Control and signal cable   |                     |        |  |
|------|------|------|------|-----------------|----------------------|--|---------------------|--------|--|
|      |      |      |      |                 |                      |  |                     |        |  |
|      |      |      |      |                 |                      | 0.75 mm <sup>2</sup>   | 1.5 mm <sup>2</sup> |        |  |
| Type | L mm | D mm | H mm | max. Cable-Ø mm | Number of conductors |  | Art.-No.            |        |  |
| MR   | 02   | 120  | 26   | 40              | 16                   | 8  | 5                   | 124507 |  |
|      | 05   | 180  | 26   | 40              | 16                   | 16   | 8                   | 124508 |  |