

## LUXeye Sense DALI BT

LUXeye Sense DALI BT | Light management systems



### Areas of application

- Offices
- Conference rooms
- Training rooms
- Corridors
- Surface mounting via LUXeye SENSE CM KIT

### Product family benefits

- Automatic start of light regulation after power-on (out of the box function)
- Basic functionality without configuration thanks to applied pre-settings
- Easy and fast customization of important parameter via screwdriver
- $V(\lambda)$  corrected light sensor element
- Predefined and customizable configurations for all applications
- Password protection for user and configuration APP access
- Easy report generation of all commissioned sensors
- Easy report sharing via email
- DEMO Mode usable without device

## Product datasheet

---

### Product family features

- One DALI broadcast output channel
- Daylight-dependent regulation and presence-dependent control of light
- Operation via standard pushbutton
- Outputs with electronical reversible short-circuit and overload protection
- Change of delay time with screwdriver direct at the sensor
- Change of lighting intensity with screwdriver direct at the sensor
- Halogen free polycarbonate plastic housing
- Controller with integrated light and presence sensor, DALI output channel
- Presence detection via passive IR element
- Light control with app connection via Bluetooth
- Light control via smart phone
- Adjustment of all settings via smartphone
- Individual activation and deactivation of light and presence sensor
- Function indicator with three color LED
- Various shutters included for different detection areas

## Product datasheet

### Technical data

#### Electrical data

Nominal voltage	220...240 V
Mains frequency	50...60 Hz
System wattage	0.40 W

#### Dimensions & weight

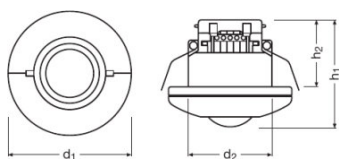

Diameter	95.0 mm
Height	81.0 mm
Product weight	144.00 g
Mounting hole spacing, diagonal	68...80 mm

#### Colors & materials

Product color	White
---------------	-------

#### Temperatures & operating conditions

Ambient temperature range	0...+55 °C
---------------------------	------------

#### Capabilities

Dimmable	No
Dimming interface	DALI
Transmitter range	15 m
Maximum installation height	5 m
Detection area	10 m <sup>1)</sup>
Detection angle	110 °
Type of installation	Ceiling integration
Operating range, light sensor	20...5000 lx <sup>2)</sup>
Number of control outputs	20

## Product datasheet

1) Diameter for movement detection at 5 m installation high

2) Approximately, measured at the sensor

### Certificates & standards

Type of protection	IP20
Protection class	II

### Logistical data

Commodity code	853710989900
----------------	--------------





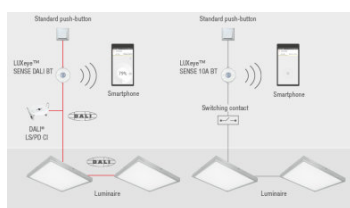

### Equipment / Accessories

- Suitable for up to 20 electronic control gears
- Free App for iOS and Android



### Circuit diagram

### Download Data

File	
	User instruction 728511_LUXeye Sense DALI BT User Instruction
	Declarations of conformity 9C1-3433399-EN-01 LUXEYE SENSE (EN)
	CAD data Luxeye Sense STEP 111119
	CAD data Luxeye Sense IGS 111119
	CAD Data 2-dim Luxeye Sense CAD2PDF 111119
	CAD data 3-dim Luxeye Sense CAD3PDF 111119

## Product datasheet



Product movie  
729682\_How to install LUXeye (EN)

### Logistical Data

Product code	Product description	Packaging unit (Pieces/Unit)	Dimensions (length x width x height)	Volume	Gross weight
4052899957411	LUXeye Sense DALI BT	Shipping carton box 12	495 mm x 265 mm x 192 mm	25.19 dm <sup>3</sup>	3285.00 g

The mentioned product code describes the smallest quantity unit which can be ordered. One shipping unit can contain one or more single products. When placing an order, for the quantity please enter single or multiples of a shipping unit.

### Disclaimer

Subject to change without notice. Errors and omission excepted. Always make sure to use the most recent release.